

SHRINK FIT CHUCK

- Made of high-temperature steel and fit for High frequency heating machine.
- For clamping cutting tools with cylinderic shank tolerance h6
- High tool-gripping strength and machining accuracy
- 360 degree concentric clamping without set screws, collets.
- Engineered to produce the high degree of balance available
- With indicating line for shank depth of cutter.

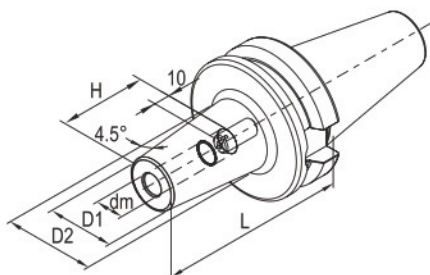
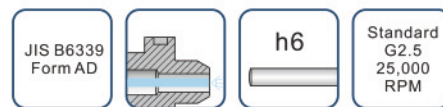

Order No.	Model	Shank	Size(mm)					Screw
			dm	D1	D2	L	H	
122-02-301	BT30-SFX03-60	BT30-AD	3	10	-	60	10	-
122-02-302	BT30-SFX04-60	BT30-AD	4	10	-	60	12	-
122-02-303	BT30-SFX05-60	BT30-AD	5	10	-	60	15	-
122-02-304	BT30-SFX06-80	BT30-AD	6	21	27	80	36	S005014C
122-02-305	BT30-SFX06-105	BT30-AD	6	21	27	105	36	S005014C
122-02-306	BT30-SFX06-120	BT30-AD	6	21	27	120	36	S005014C
122-02-307	BT30-SF08-80	BT30-AD	8	21	27	80	36	S006014C
122-02-308	BT30-SF08-105	BT30-AD	8	21	27	105	36	S006014C
122-02-309	BT30-SF08-120	BT30-AD	8	21	32	120	36	S006014C
122-02-310	BT30-SF10-80	BT30-AD	10	24	32	80	42	S008014C
122-02-311	BT30-SF10-105	BT30-AD	10	24	32	105	42	S008014C
122-02-312	BT30-SF10-120	BT30-AD	10	24	32	120	42	S008014C
122-02-313	BT30-SF12-80	BT30-AD	12	24	32	80	47	S008014C
122-02-314	BT30-SF12-105	BT30-AD	12	24	32	105	47	S008014C
122-02-315	BT30-SF12-120	BT30-AD	12	24	34	120	47	S008014C
122-02-316	BT30-SF14-80	BT30-AD	14	27	34	80	47	S008014C
122-02-317	BT30-SF14-105	BT30-AD	14	27	34	105	47	S008014C
122-02-318	BT30-SF14-120	BT30-AD	14	27	34	120	47	S008014C
122-02-319	BT30-SF16-80	BT30-AD	16	27	34	80	50	S012014C
122-02-320	BT30-SF16-105	BT30-AD	16	27	34	105	50	S012014C
122-02-321	BT30-SF16-120	BT30-AD	16	27	34	120	50	S012014C
122-02-401	BT40-SFX03-80	BT40-AD	3	10	-	80	10	-
122-02-402	BT40-SFX04-80	BT40-AD	4	10	-	80	12	-
122-02-403	BT40-SFX05-80	BT40-AD	5	10	-	80	15	-
122-02-404	BT40-SFX06-90	BT40-AD	6	21	27	90	36	S005014C
122-02-405	BT40-SFX06-120	BT40-AD	6	21	27	120	36	S005014C
122-02-406	BT40-SFX06-160	BT40-AD	6	21	32	160	36	S005014C
122-02-407	BT40-SF08-90	BT40-AD	8	21	27	90	36	S006014C
122-02-408	BT40-SF08-120	BT40-AD	8	21	27	120	36	S006014C
122-02-409	BT40-SF08-160	BT40-AD	8	21	32	160	36	S006014C
122-02-410	BT40-SF10-90	BT40-AD	10	24	32	90	42	S008014C
122-02-411	BT40-SF10-120	BT40-AD	10	24	32	120	42	S008014C
122-02-412	BT40-SF10-160	BT40-AD	10	24	34	160	42	S008014C
122-02-413	BT40-SF12-90	BT40-AD	12	24	32	90	47	S008014C
122-02-414	BT40-SF12-120	BT40-AD	12	24	32	120	47	S008014C
122-02-415	BT40-SF12-160	BT40-AD	12	24	34	160	47	S008014C
122-02-416	BT40-SF14-90	BT40-AD	14	27	34	90	47	S008014C
122-02-417	BT40-SF14-120	BT40-AD	14	27	34	120	47	S008014C
122-02-418	BT40-SF14-160	BT40-AD	14	27	42	160	47	S008014C
122-02-419	BT40-SF16-90	BT40-AD	16	27	34	90	50	S012014C
122-02-420	BT40-SF16-120	BT40-AD	16	27	34	120	50	S012014C
122-02-421	BT40-SF16-160	BT40-AD	16	27	42	160	50	S012014C
122-02-422	BT40-SF18-90	BT40-AD	18	33	42	90	50	S012014C
122-02-423	BT40-SF18-120	BT40-AD	18	33	42	120	50	S012014C
122-02-424	BT40-SF18-160	BT40-AD	18	33	51	160	50	S012014C
122-02-425	BT40-SF20-90	BT40-AD	20	33	42	90	52	S016016C
122-02-426	BT40-SF20-120	BT40-AD	20	33	42	120	52	S016016C
122-02-427	BT40-SF20-160	BT40-AD	20	33	51	160	52	S016016C
122-02-428	BT40-SF25-100	BT40-AD	25	44	53	100	58	S016016C
122-02-429	BT40-SF25-120	BT40-AD	25	44	53	120	58	S016016C
122-02-430	BT40-SF25-160	BT40-AD	25	44	60	160	58	S016016C

SHRINK FIT CHUCK

- Made of high-temperature steel and fit for High frequency heating machine.
- For clamping cutting tools with cylinderic shank tolerance h6
- High tool-gripping strength and machining accuracy
- 360 degree concentric clamping without set screws, collets.
- Engineered to produce the high degree of balance available
- With indicating line for shank depth of cutter.

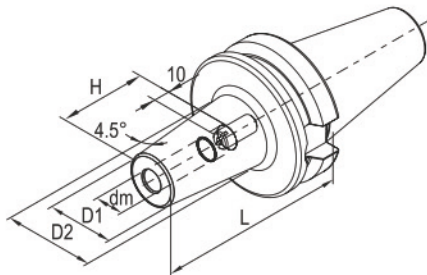
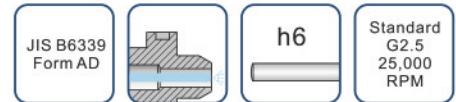

Order No.	Model	Shank	Size(mm)					Screw
			dm	D1	D2	L	H	
122-02-501	BT50-SFX06-100	BT50-AD	6	21	27	100	36	S005014C
122-02-502	BT50-SFX06-120	BT50-AD	6	21	27	120	36	S005014C
122-02-503	BT50-SFX06-160	BT50-AD	6	21	32	160	36	S005014C
122-02-504	BT50-SF08-100	BT50-AD	8	21	27	100	36	S006014C
122-02-505	BT50-SF08-120	BT50-AD	8	21	27	120	36	S006014C
122-02-506	BT50-SF08-160	BT50-AD	8	21	32	160	36	S006014C
122-02-507	BT50-SF10-100	BT50-AD	10	24	32	100	42	S008014C
122-02-508	BT50-SF10-120	BT50-AD	10	24	32	120	42	S008014C
122-02-509	BT50-SF10-160	BT50-AD	10	24	34	160	42	S008014C
122-02-510	BT50-SF12-100	BT50-AD	12	24	32	100	47	S008014C
122-02-511	BT50-SF12-120	BT50-AD	12	24	32	120	47	S008014C
122-02-512	BT50-SF12-160	BT50-AD	12	24	34	160	47	S008014C
122-02-513	BT50-SF14-100	BT50-AD	14	27	34	100	47	S008014C
122-02-514	BT50-SF14-120	BT50-AD	14	27	34	120	47	S008014C
122-02-515	BT50-SF14-160	BT50-AD	14	27	42	160	47	S008014C
122-02-516	BT50-SF16-100	BT50-AD	16	27	34	100	50	S012014C
122-02-517	BT50-SF16-120	BT50-AD	16	27	34	120	50	S012014C
122-02-518	BT50-SF16-160	BT50-AD	16	27	42	160	50	S012014C
122-02-519	BT50-SF18-100	BT50-AD	18	33	42	100	50	S012014C
122-02-520	BT50-SF18-120	BT50-AD	18	33	42	120	50	S012014C
122-02-521	BT50-SF18-160	BT50-AD	18	33	51	160	50	S012014C
122-02-522	BT50-SF20-100	BT50-AD	20	33	42	100	52	S016016C
122-02-523	BT50-SF20-120	BT50-AD	20	33	42	120	52	S016016C
122-02-524	BT50-SF20-160	BT50-AD	20	33	51	160	52	S016016C
122-02-525	BT50-SF25-110	BT50-AD	25	44	53	110	58	S016016C
122-02-526	BT50-SF25-135	BT50-AD	25	44	60	135	58	S016016C
122-02-527	BT50-SF25-160	BT50-AD	25	44	60	160	58	S016016C
122-02-528	BT50-SF32-110	BT50-AD	32	44	53	110	58	S016016C
122-02-529	BT50-SF32-135	BT50-AD	32	44	60	135	58	S016016C
122-02-530	BT50-SF32-160	BT50-AD	32	44	60	160	58	S016016C